

STAFFORD STREET ROADWORKS - JUNE - AUGUST

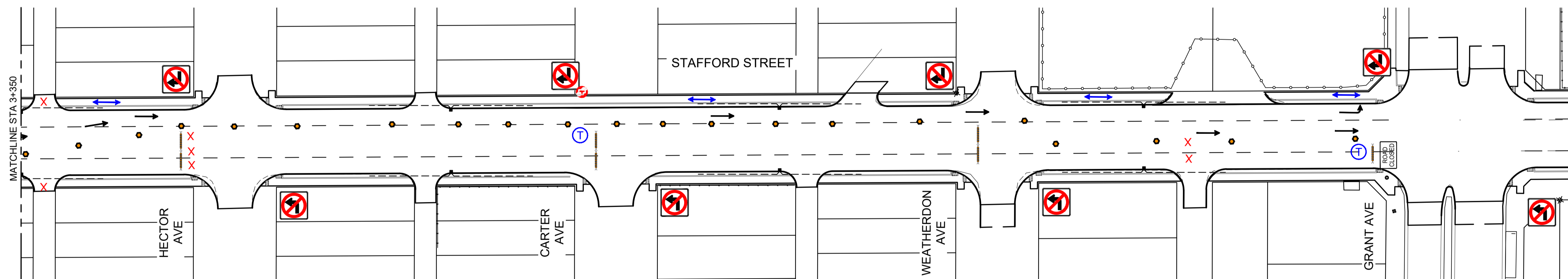
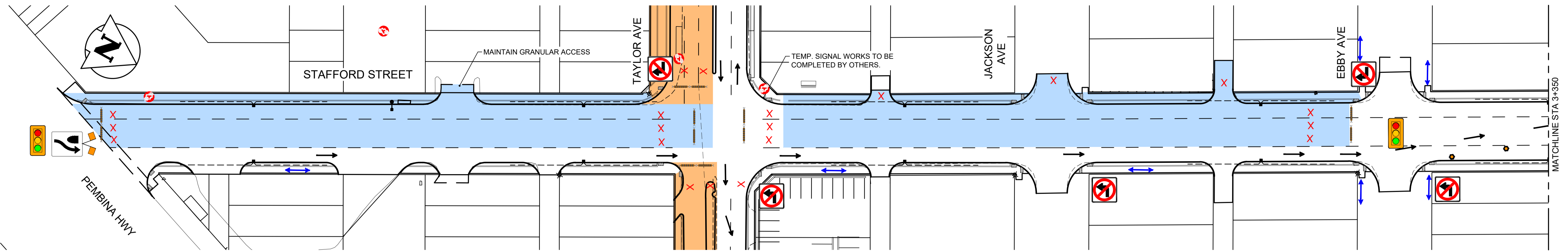

LEGEND

- 2023 CONSTRUCTION STAFFORD JUNE - JULY
- 2023 CONSTRUCTION TAYLOR MAY - OCTOBER
- TEMPORARILY CLOSED TRANSIT STOP
- T TEMPORARY TRANSIT STOP
- TRAFFIC FLOW
- X LANE CLOSED TO TRAFFIC
- PEDESTRIAN AND CYCLIST FLOW (AS APPLICABLE)

WARNING

IF POWER EQUIPMENT OR EXPLOSIVES ARE TO BE USED FOR EXCAVATION ON THIS PROJECT THE CONTRACTOR MUST:

- 1) NOTIFY THE GAS COMPANY OF THE PROPOSED LOCATION OF EXCAVATION.
 - 2) TAKE PRECAUTION TO AVOID DAMAGE TO GAS COMPANY INSTALLATIONS.
- SEE PROVINCIAL REGULATION 140/92 FOR DETAILS

METRIC

WHOLE NUMBERS INDICATE MILLIMETRES
DECIMALIZED NUMBERS INDICATE METRES

150 WM	WATERMAIN	150 WM	HYDRO	300 LIDS	LAND DRAINAGE SEWER	300 LIDS	250 WWS	WASTE WATER SEWER	250 WWS	MANHOLE	CATCH BASIN	CURB INLET/CATCH PIT	TRANSIT STOP	CULVERT	GAS	EXISTING	LEGEND-PLAN	PROPOSED	EXISTING	LEGEND-PLAN	PROPOSED	EXISTING	LEGEND-PROFILE	PROPOSED
⊕	HYDRANT	⊕	M.T.S.	⊕	VALVE	⊕	○	MANHOLE	○	□	CATCH BASIN	▽	●	▬	▬	▬	▬	▬	▬	▬	▬	▬	▬	▬
⊕	LAND DRAINAGE SEWER	⊕	CONCRETE	⊕	ASPHALT	⊕	▬	SIDEWALK	▬	▬	MILL JOINT	▬	▬	▬	▬	▬	▬	▬	▬	▬	▬	▬	▬	▬
▬	WASTE WATER SEWER	▬	ASPHALT	▬	SIDEWALK	▬	▬	MILL JOINT	▬	▬	PROPERTY LINE	▬	▬	▬	▬	▬	▬	▬	▬	▬	▬	▬	▬	▬
▬	MANHOLE	▬	CONCRETE	▬	ASPHALT	▬	▬	SIDEWALK	▬	▬	PROPERTY LINE	▬	▬	▬	▬	▬	▬	▬	▬	▬	▬	▬	▬	▬
▬	CATCH BASIN	▬	CONCRETE	▬	ASPHALT	▬	▬	SIDEWALK	▬	▬	PROPERTY LINE	▬	▬	▬	▬	▬	▬	▬	▬	▬	▬	▬	▬	▬
▬	CURB INLET/CATCH PIT	▬	CONCRETE	▬	ASPHALT	▬	▬	SIDEWALK	▬	▬	PROPERTY LINE	▬	▬	▬	▬	▬	▬	▬	▬	▬	▬	▬	▬	▬
▬	TRANSIT STOP	▬	CONCRETE	▬	ASPHALT	▬	▬	SIDEWALK	▬	▬	PROPERTY LINE	▬	▬	▬	▬	▬	▬	▬	▬	▬	▬	▬	▬	▬
▬	CULVERT	▬	CONCRETE	▬	ASPHALT	▬	▬	SIDEWALK	▬	▬	PROPERTY LINE	▬	▬	▬	▬	▬	▬	▬	▬	▬	▬	▬	▬	▬
▬	GAS	▬	CONCRETE	▬	ASPHALT	▬	▬	SIDEWALK	▬	▬	PROPERTY LINE	▬	▬	▬	▬	▬	▬	▬	▬	▬	▬	▬	▬	▬
▬	LEGEND-PLAN	▬	CONCRETE	▬	ASPHALT	▬	▬	SIDEWALK	▬	▬	PROPERTY LINE	▬	▬	▬	▬	▬	▬	▬	▬	▬	▬	▬	▬	▬
▬	PROPOSED	▬	CONCRETE	▬	ASPHALT	▬	▬	SIDEWALK	▬	▬	PROPERTY LINE	▬	▬	▬	▬	▬	▬	▬	▬	▬	▬	▬	▬	▬
▬	EXISTING	▬	CONCRETE	▬	ASPHALT	▬	▬	SIDEWALK	▬	▬	PROPERTY LINE	▬	▬	▬	▬	▬	▬	▬	▬	▬	▬	▬	▬	▬

LOCATION APPROVED UNDERGROUND STRUCTURES

SUPV. U/G STRUCTURES COMMITTEE DATE

NOTE:
LOCATION OF UNDERGROUND STRUCTURES AS SHOWN ARE BASED ON THE BEST INFORMATION AVAILABLE BUT NO GUARANTEE IS GIVEN THAT ALL EXISTING UTILITIES ARE SHOWN OR THAT THE GIVEN LOCATIONS ARE EXACT. CONFIRMATION OF EXISTENCE AND EXACT LOCATION OF ALL SERVICES MUST BE OBTAINED FROM THE INDIVIDUAL UTILITIES BEFORE PROCEEDING WITH CONSTRUCTION.

B.M. ELEV.					
NO.	REVISIONS	DATE	BY	DATE	2021/02/16

Stantec
500 - 311 Portage Avenue, Winnipeg MB Canada
www.stantec.com

DESIGNED BY: T.G. CHECKED BY: K.W.R.
DRAWN BY: V.K. APPROVED BY: K.W.R.

HOR. SCALE: 1:500
VERTICAL: _____

ISSUED FOR TENDER: 21.12.20 K.W.R.
DATE: 2021/02/16

ENGINEER'S SEAL

PRELIMINARY DRAWING

NOT TO BE USED FOR CONSTRUCTION

CONSULTANT DRAWING NO. C-724

THE CITY OF WINNIPEG
PUBLIC WORKS DEPARTMENT
ENGINEERING DIVISION

2019-2023 STAFFORD/TAYLOR/CORYDON
TENDER 2
STAFFORD STREET
PEMBINA HWY TO GRANT AVENUE
2023 CONSTRUCTION

SHEET 49 OF 53
CAD FILE DRAWING NUMBER 08020c-724-932.dwg
CITY DRAWING NUMBER P-3526-39

I:\11782620\0820_08020c-724-932.dwg 2021/11/24 2:29:40 PM K.W.R. Cell: 118